



## **Waste Management Plan – Demolition and Constuction Waste**



**The applicable sections of this Waste Management Plan (WMP) must be completed and submitted with your Development Application.**

Completing this Plan will assist you in identifying the type(s) of demolition and construction waste that will be generated and will inform Council how you intend to reuse, recycle or dispose of this waste. The more detail you provide with your application will assist Council in reviewing your application. The amount of detail you provide with your application impacts the number of revisions and time taken with processing the DA.

The information you provide will be assessed against the objectives of the Development Control Plan 2021.

If you require assistance completing your WMP, please contact Council's Waste Assessment Officers in the Resource Recovery Team on **9707 9000**.

If there is insufficient space within this template, please provide attachments.

Site address: <b>2 Brockman Ave,</b>	
Suburb:Revesby Heights	Postcode:2212

Applicant's name: Tarek Noun and Ribal Noun	
Company name: NA	
Applicant's address:113 centaur st	
Suburb: Revesby heights	Postcode:2212
Phone: 0411 275 257	Mobile:0401 160 423
Email:ribalnoun@gmail.com	

Are there buildings or structures currently on the site?	
No	Yes – current single storey weather board house with tiles.
If the application involves the demolition of a residential property, has a Vacant Land Charge Application been submitted? <a href="https://www.cbccity.nsw.gov.au/council/forms/waste-recycling">https://www.cbccity.nsw.gov.au/council/forms/waste-recycling</a>	
No	Yes (pending)

Applicant's Signature:	
Date:	
If proposal has been discussed with Council's Waste Assessment Officers provide details.	N/A

**DEMOLITION WASTE** (Complete if there are existing structures on site that require removal)

Do the works involve asbestos removal?	Yes – less than 10m <sup>2</sup>	X	Yes – more than 10m <sup>2</sup>		No	
Work Cover License number: To be provided prior to commencement of work						

**GENERAL DEMOLITION WASTE**

Has a demolition contractor been appointed?	Yes		No	X
If yes, demolition contractor details:				
If no and if DA is approved, a condition of consent may be placed on the DA requiring the above details prior to works commencing on-site.				

Type of material	Estimated Amount m <sup>2</sup> or m <sup>3</sup>	Destination		
		Reuse and recycling		Disposal
		ON-SITE Specify proposed reuse	OFF-SITE Specify contractor and recycling facility	Specify contractor and landfill site
Excavation (e.g. soil, rock)	NA			
Bricks/Pavers	10m <sup>3</sup>		10m <sup>3</sup>	Recycling facility
Concrete	3m <sup>3</sup>		3m <sup>3</sup>	Recycling facility
Tiles	0.5m <sup>3</sup>		0.5m <sup>3</sup>	Landfill
Timber (clean)	12m <sup>3</sup>		12m <sup>3</sup>	Recycling facility
Timber (treated)	NA			
Asphalt	NA			
Metals	1m <sup>3</sup>		1m <sup>3</sup>	Recycling facility
Plasterboard	39m <sup>2</sup>		39m <sup>2</sup>	Landfill
Green waste	2m <sup>3</sup>	2m <sup>3</sup>		
Glass	10m <sup>2</sup>		10m <sup>2</sup>	Recycling facility
Furniture/Fittings/Carpet	na			
Other - specify				
Percentage of material diverted from landfill: 96%				
If this figure is below 80%, you must explain why. *				

**CONSTRUCTION WASTE**

Type of material	Estimated amount m <sup>2</sup> or m <sup>3</sup>	Destination		
		Reuse and recycling		Disposal
		ON-SITE Specify proposed reuse	OFF-SITE Specify contractor and recycling facility	Specify contractor and landfill site
Excavation (e.g. soil, rock)	120m <sup>3</sup>	100m <sup>3</sup>	20m <sup>3</sup>	Landfill
Bricks/Pavers	1m <sup>3</sup>		1m <sup>3</sup>	Recycling facility
Concrete	1m <sup>3</sup>		1m <sup>3</sup>	Recycling facility
Tiles	0.3m <sup>3</sup>		0.3m <sup>3</sup>	Recycling facility
Timber (clean)	0.5m <sup>3</sup>		0.5m <sup>3</sup>	Recycling facility
Timber (treated)	NA			
Asphalt	NA			
Metals	NA			
Plasterboard	NA			
Green waste	NA			
Glass	NA			
Furniture/Fittings/Carpet	NA			
Other - specify				
Percentage of material diverted from landfill: 84%				
If this figure is below 80%, you must explain why.*				

\* Council has a target of diverting 80% of waste from landfill. To contribute to this target, all developments are required to achieve best practise in the design, construction and maintenance of waste management facilities and infrastructure.

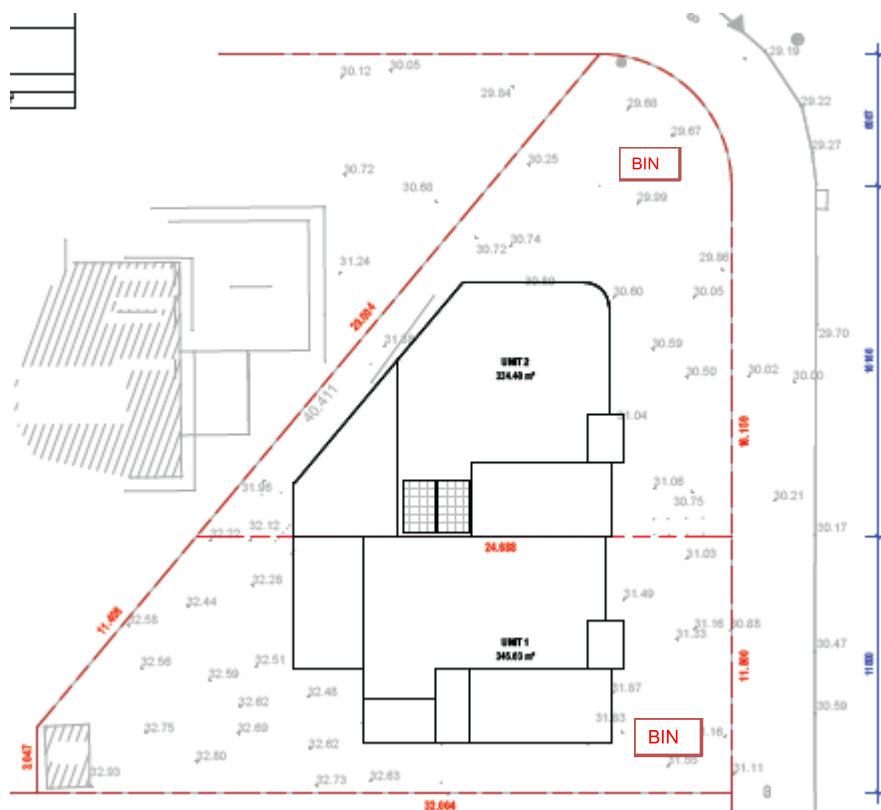

A site plan showing storage areas away from public access for reusable materials and recyclables during demolition and construction, and the vehicle access to these areas

I certify that:

- (a) Any material moved off-site will be transported in accordance with the requirements of the *Protection of the Environment Operations Act 1997*;
- (b) Waste will only be transported to a place that can lawfully be used as a waste facility;
- (c) Generation, storage, treatment and disposal of hazardous waste and special waste (including asbestos) will be conducted in accordance with relevant waste legislation administered by the EPA and relevant Work Health and Safety legislation administered by WorkCover NSW; and
- (d) All records demonstrating lawful disposal of waste and evidence such as weighbridge dockets and invoices for waste disposal or recycling services will be retained and kept readily accessible for inspection by regulatory authorities such as Council, NSW EPA or WorkCover NSW.

Signature \_\_\_\_\_

Date \_\_\_\_\_